

DPCB Punched Plain Copper Busbar, Single

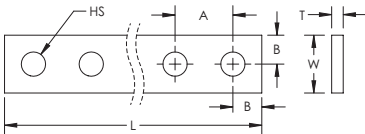

- Heavy-duty power connection
- Circuit breaker, generator and prefabricated power network conductor
- Alternative to large and multiple cables
- Earth/ground connection
- Power distribution
- Rounded edges



Material: Copper

Part Number	Article Number	Width W	Thickness T	Length L	Hole Size HS	A	B	Unit Weight
DPCB25X5	550400	25 mm	5 mm	1,750 mm	10.5 mm	25 mm	12.5 mm	1.4 kg

WARNING

nVent products shall be installed and used only as indicated in nVent's product instruction sheets and training materials. Instruction sheets are available at www.erico.com and from your nVent customer service representative. Improper installation, misuse, misapplication or other failure to completely follow nVent's instructions and warnings may cause product malfunction, property damage, serious bodily injury and death and/or void your warranty.

© 2019 nVent All rights reserved

nVent, nVent CADDY, nVent ERICO, nVent ERIFLEX and nVent LENTON are owned by nVent or its global affiliates.

All other trademarks are the property of their respective owners. nVent reserves the right to change specifications without prior notice.